

Y4 Residential Trip Parent Information Meeting

Tuesday 21st June 2022



The Frontier Centre

Monday 17th – Tuesday 18th October 2022

- Mrs Bush – Headteacher
- Class Teacher
- Teaching Assistant

LET YOUR LIGHT SHINE 



Frontier Centre, Irthlingborough

Location & Travel

The Frontier Centre is set in Northamptonshire in the heart of England and surrounded by beautiful countryside. The centre has 122 acres of woodland, a river and lake for water sports and open grounds with stunning views across Stanwick Lakes, a nature reserve along the picturesque Nene Valley.

Rock UK
Frontier Centre,
Addington Road,
Irthlingborough,
Northamptonshire,
NN9 5UH,



LET YOUR LIGHT SHINE



What is the Frontier Centre?

- A Christian organisation that is passionate about developing young people, bringing adventure into learning in the outdoors,
- Four adventure centres across the UK.
- All outdoor adventure activities encourage the development of social and personal skills.
- All centres are AALA licensed (Adventure Activities Licensing Authority) and hold the LOtC (Learning Outside the Classroom) Quality Badge.
- Fully qualified instructors will tailor each activity session to meet the age and experience of the group, giving a real taste of adventure whilst teaching important lessons such as leadership skills, environmental awareness, personal responsibility and teamwork.

LET YOUR LIGHT SHINE



Mr McGregor's Garden



Why do we go?

- Develop self-confidence
- Greater independence and responsibility
- Promote team-building skills
- Face new challenges
- Opportunity to shine!

Dear God
Thank you
for the world
and everything
in it
Amen

Accommodation

- Lodge style accommodation with shower and toilet facilities.
- Dormitory style bedrooms which sleep groups of 3 to 6 children in each.
- Full bedding provided.

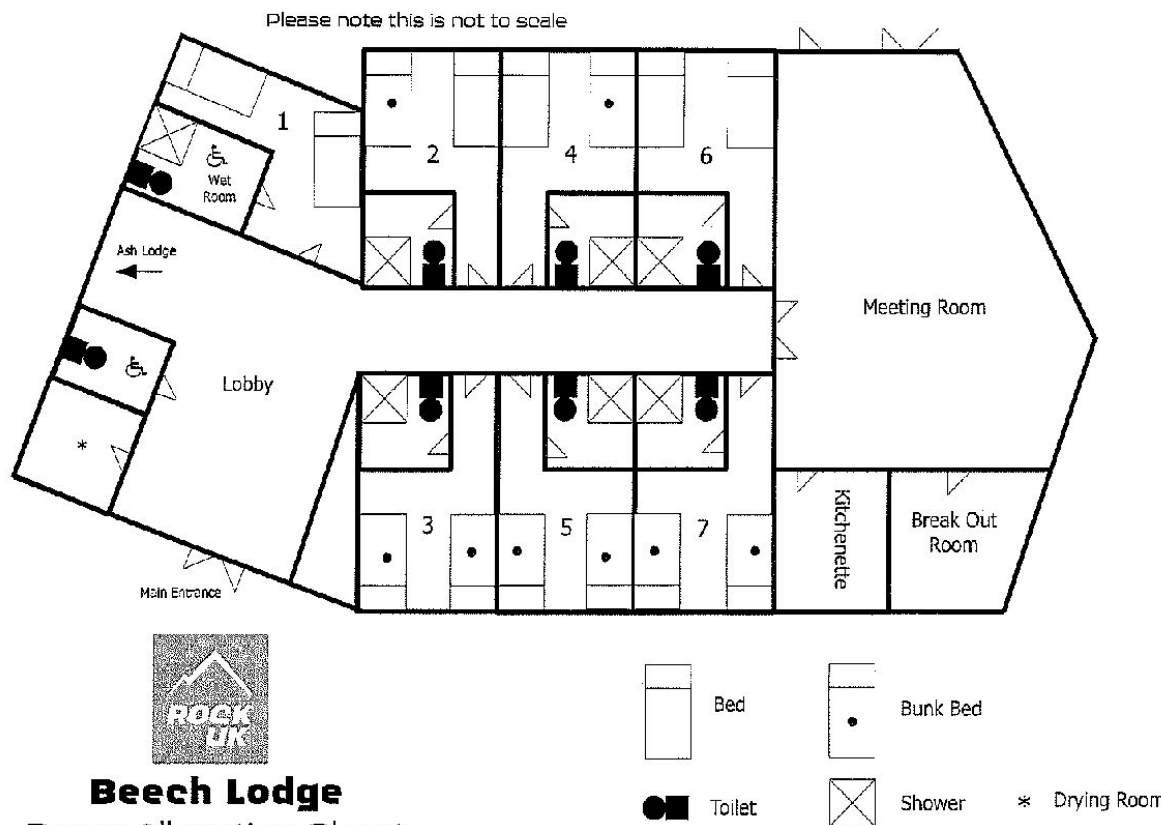

Beech Lodge

Room Allocation Sheet



GENEROUS AND BRAVE

LET YOUR LIGHT SHINE



Travel Arrangements

- Monday 17th October 2022
Parents to drop children at the Frontier Centre, Beech Lounge
between 9.30 – 10.00 a.m.
- A packed lunch in a disposable bag will be required for the first day.
- Tuesday 18th October 2022
Parents to collect children from the Frontier Centre at 2.00 p.m.
- Parents may wish to consider car sharing.



Meals

- Meals are catered only and served in the main dining room
- Any special dietary requirements catered for
- All food is freshly produced and is nutritionally balanced to help to fuel the energetic activity sessions.
- Breakfast is typically a selection of cereals, fruit, yogurt and toast.
- Lunch is usually filled rolls, fruit, crisps, a chocolate bar and a drink.
- Hot lunches and dinners are typically a main and pudding.



Itinerary

Date	Activities	Main Activity
Monday 17/10/22		
09:30 – 10:00	Arrival at Frontier Centre	
10:00 – 12:00	Walk to Stanwick Lakes	
12:00 – 13:00	Packed Lunch	
13:00 – 14:00	Adventure Play	
14:15 – 15:15	Group 1 – Indoor Climbing	Indoor Climbing
14:15 – 16:00	Group 2 – Raft Building	
15:15 – 17:00	Hardcourt	
16:15 – 18:00	Group 1 – Raft Building	Raft Building
17:15 – 18:15	Group 2 – Indoor Climbing	
18:30 – 19:30	Dinner	
19:30 – 20:30	Walk the Plank	
Tuesday 18/10/22		
08:45 – 09:45	Breakfast	
09:30 – 11:00	Adventure Pits	
11:00 – 12:45	Sports Activities	
13:00 – 14:00	Lunch	
14:00	Depart	

Dear God
Thank you
for the world
and everything
in it
Amen





LET YOUR LIGHT SHINE





Kit List

- One holdall (soft luggage preferred and must be manageable)
- One towel
- Toiletries bag containing: toothbrush, toothpaste, soap, hairbrush etc.
- Night clothes
- Socks and underwear
- Two t-shirts (at least one with long sleeves)
- One sweatshirt/hoodie
- Tracksuit bottoms / leggings for day time
- Comfortable clothes for the evening
- Waterproof jacket (and trousers if you have them)
- Sturdy shoes or wellington boots (depending on weather)
- One pair of trainers (preferably an old pair)
- Large plastic bag for dirty clothes
- Gloves, hat, scarf
- Water bottle which can be refilled.



Do not bring:

- Mobile phones, expensive cameras, electronic games, iPods or MP3 players
- Jewellery
- Expensive or favourite clothing or shoes

The Frontier Centre cannot accept liability for the loss, theft or damage or an personal property your child may bring.

LET YOUR LIGHT SHINE



Next Steps

- Information Pack
- Forms to be completed and returned to the school office by Friday 8th July
 - Medical, dietary and special requirements
 - Parental consent form
- Full cost of the trip is £100 (dependent on numbers)
- £20.00 deposit to be paid by Friday 8th July 2022
- Suggested payment plan:
 - * 08th August £27
 - * 08th September £27
 - * 08th October £26

Thank you for your time

Any Questions?

